

# Enhancement Mode Field Effect Transistor

N-Channel

## 2N7002W

### Features

- Low On-Resistance
- Low Gate Threshold Voltage
- Low Input Capacitance
- Fast Switching Speed
- Low Input/Output Leakage
- Ultra-Small Surface Mount Package
- These Devices are Pb-Free and are RoHS Compliant

### ABSOLUTE MAXIMUM RATINGS (T<sub>A</sub> = 25°C unless otherwise noted)

| Parameter   | Symbol                            | Value            | Unit |
|---|-----------------------------------|------------------|------|
| Drain-to-Source Voltage   | V <sub>DSS</sub>                  | 60               | V    |
| Drain-Gate Voltage R <sub>GS</sub> ≤ 1.0 MΩ                       | V <sub>DGR</sub>                  | 60               | V    |
| Gate-Source Voltage<br>Continuous<br>Pulsed                       | V <sub>GSS</sub>                  | ±20<br>±40       | V    |
| Gate-Source Voltage<br>Continuous<br>Continuous @ 100°C<br>Pulsed | I <sub>D</sub>                    | 115<br>73<br>800 | mA   |
| Junction and Storage Temperature Range                            | T <sub>J</sub> , T <sub>STG</sub> | -55 to<br>+150   | °C   |

Stresses exceeding those listed in the Maximum Ratings table may damage the device. If any of these limits are exceeded, device functionality should not be assumed, damage may occur and reliability may be affected.

### THERMAL CHARACTERISTICS

| Parameter  | Symbol           | Max        | Unit        |
|--|------------------|------------|-------------|
| Total Device Dissipation<br>Derating above T <sub>A</sub> = 25°C | P <sub>D</sub>   | 200<br>1.6 | MW<br>mW/°C |
| Thermal Resistance, Junction-to-Ambient<br>(Note 1)              | R <sub>θJA</sub> | 625        | °C/W        |

1. Device mounted on FR-4 PCB, 1 inch × 0.85 inch × 0.062 inch. Minimum land pad size.

### SIMPLIFIED SCHEMATIC

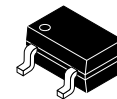
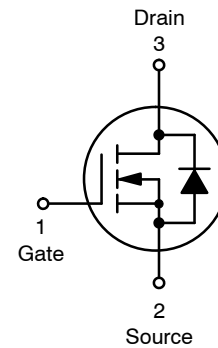

SC-70  
CASE 419AB

### MARKING DIAGRAM & PIN ASSIGNMENT

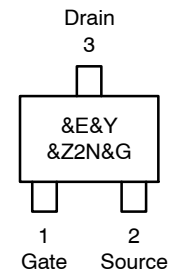

Line 1:  
&E = Space  
&Y = Binary Year Code

Line 2:  
&Z = Designates the Assembly Plant Code  
**2N** = **Specific Device Code**  
&G = 1-digit Week Code

### ORDERING INFORMATION

| Device  | Package            | Shipping <sup>†</sup> |
|---------|--------------------|-----------------------|
| 2N7002W | SC-70<br>(Pb-Free) | 3000 / Tape & Reel    |

<sup>†</sup>For information on tape and reel specifications, including part orientation and tape sizes, please refer to our Tape and Reel Packaging Specifications Brochure, BRD8011/D.

## 2N7002W

### ELECTRICAL CHARACTERISTICS ( $T_A = 25^\circ\text{C}$ unless otherwise noted)

| Parameter | Symbol | Test Condition | Min | Typ | Max | Units |
|-----------|--------|----------------|-----|-----|-----|-------|
|-----------|--------|----------------|-----|-----|-----|-------|

#### OFF CHARACTERISTICS (Note 2)

|                                 |            |   |                           |     |          |     |               |
|---------------------------------|------------|---|---------------------------|-----|----------|-----|---------------|
| Drain-Source Breakdown Voltage  | $BV_{DSS}$ | $V_{GS} = 0\text{ V}, I_D = 10\ \mu\text{A}$    | 60                        | 78  | -        | V   |               |
| Zero Gate Voltage Drain Current | $I_{DSS}$  | $V_{GS} = 0\text{ V}, V_{DS} = 60\text{ V}$     | $T_C = 25^\circ\text{C}$  | -   | 0.001    | 1.0 | $\mu\text{A}$ |
|                                 |            |   | $T_C = 125^\circ\text{C}$ | -   | 7        | 500 |               |
| Gate-Body Leakage Current       | $I_{GSS}$  | $V_{GS} = \pm 20\text{ V}, V_{DS} = 0\text{ V}$ | -                         | 0.2 | $\pm 10$ | nA  |               |

#### ON CHARACTERISTICS (Note 2)

|                                   |              |   |     |       |      |          |
|-----------------------------------|--------------|---|-----|-------|------|----------|
| Gate Threshold Voltage            | $V_{GS(th)}$ | $V_{GS} = V_{DS}, I_D = 250\ \mu\text{A}$                             | 1.0 | 1.76  | 2.0  | V        |
| Static Drain-Source On-Resistance | $R_{DS(ON)}$ | $V_{GS} = 5\text{ V}, I_D = 0.05\text{ A}$                            | -   | 1.6   | 7.5  | $\Omega$ |
|                                   |              | $V_{GS} = 10\text{ V}, I_D = 0.5\text{ A}, @ T_J = 125^\circ\text{C}$ | -   | 2.53  | 13.5 |          |
| On-State Drain Current            | $I_{D(ON)}$  | $V_{GS} = 10\text{ V}, V_{DS} = 7.5\text{ V}$                         | 0.5 | 1.43  | -    | A        |
| Forward Transconductance          | $g_{FS}$     | $V_{DS} = 10\text{ V}, I_D = 0.2\text{ A}$                            | 80  | 356.5 | -    | mS       |

#### DYNAMIC CHARACTERISTICS

|                              |           |   |   |      |     |    |
|------------------------------|-----------|---|---|------|-----|----|
| Input Capacitance            | $C_{ISS}$ | $V_{GS} = 0\text{ V}, V_{DS} = 25\text{ V}, f = 1.0\text{ MHz}$ | - | 37.8 | 50  | pF |
| Output Capacitance           | $C_{OSS}$ |   | - | 12.4 | 25  |    |
| Reverse Transfer Capacitance | $C_{RSS}$ |   | - | 6.5  | 7.0 |    |

#### SWITCHING CHARACTERISTICS

|                     |              |  |   |      |    |    |
|---------------------|--------------|--|---|------|----|----|
| Turn-On Delay Time  | $t_{D(ON)}$  | $V_{GEN} = 10\text{ V}, V_{DD} = 30\text{ V}, I_D = 0.2\text{ A}, R_L = 150\ \Omega, R_{GEN} = 25\ \Omega$ | - | 5.85 | 20 | ns |
| Turn-Off Delay Time | $t_{D(OFF)}$ |  | - | 12.5 | 20 |    |

Product parametric performance is indicated in the Electrical Characteristics for the listed test conditions, unless otherwise noted. Product performance may not be indicated by the Electrical Characteristics if operated under different conditions.

2. Short duration test pulse used to minimize self-heating effect.

TYPICAL PERFORMANCE CHARACTERISTICS

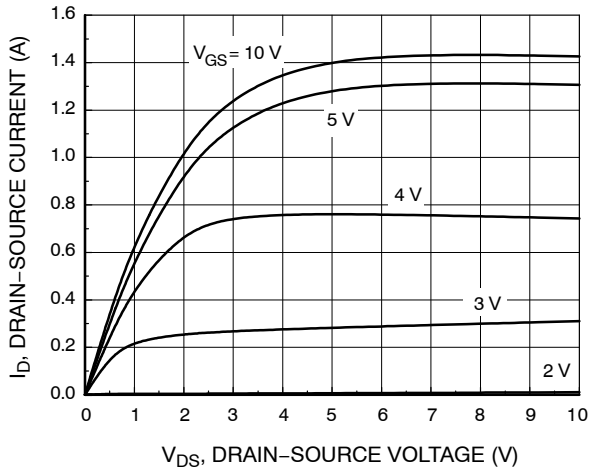

Figure 1. On-Region Characteristics

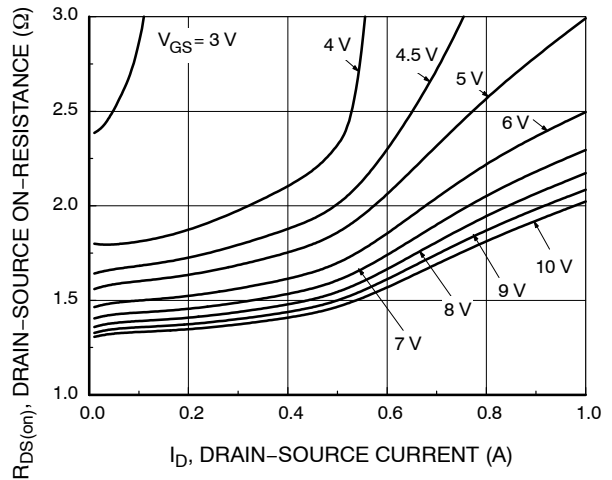

Figure 2. On-Resistance Variation with Gate Voltage and Drain Current

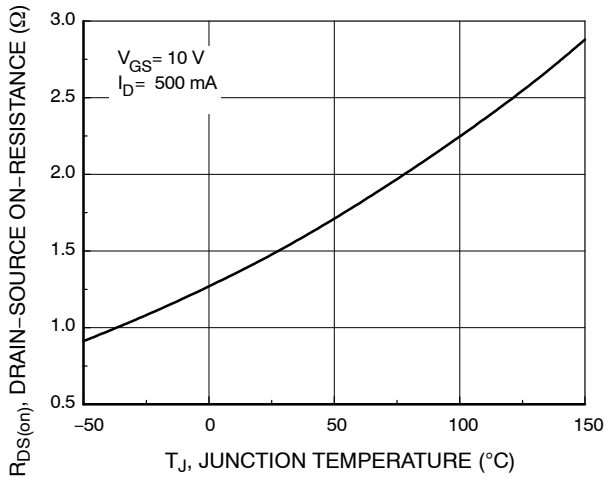

Figure 3. On-Resistance Variation with Temperature

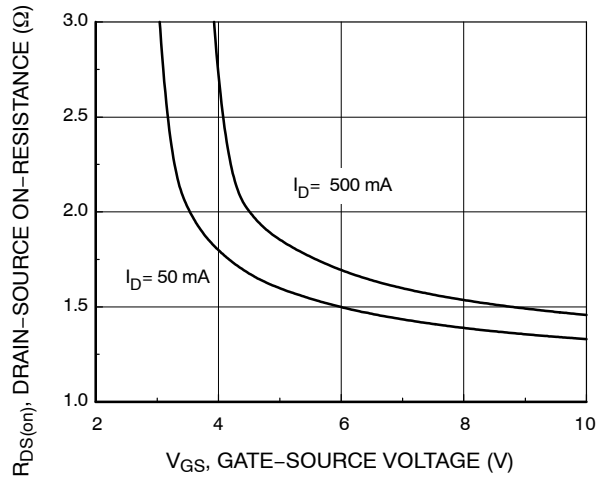

Figure 4. On-Resistance Variation with Gate-Source Voltage

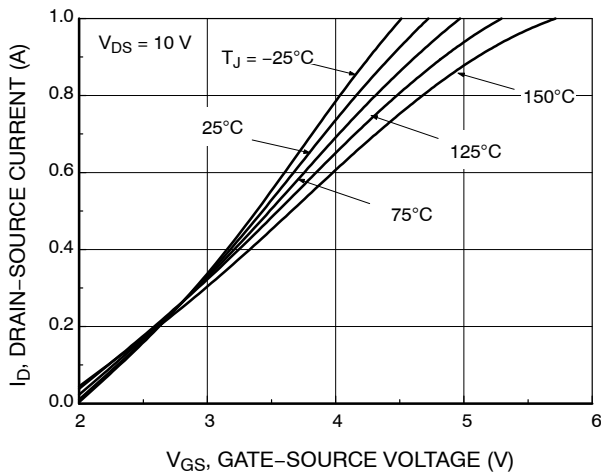

Figure 5. Transfer Characteristics

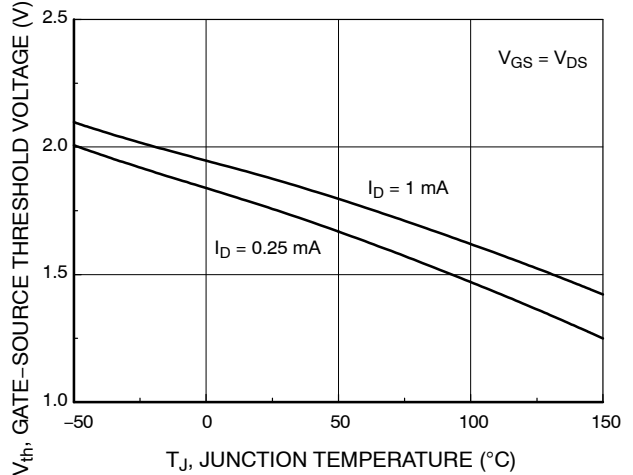

Figure 6. Gate Threshold Variation with Temperature

TYPICAL PERFORMANCE CHARACTERISTICS (Continued)

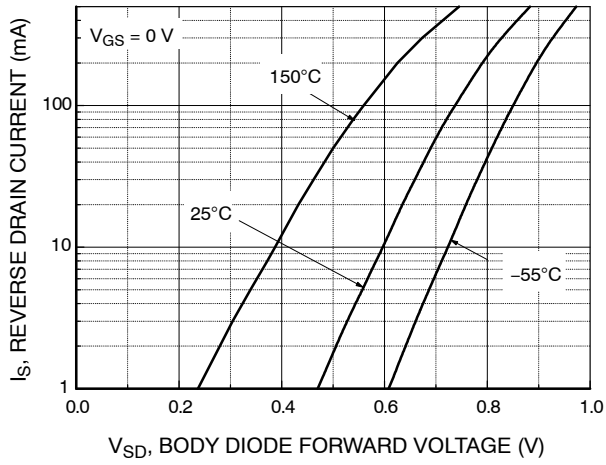

Figure 7. Reverse Drain Current Variation with Diode Forward Voltage and Temperature

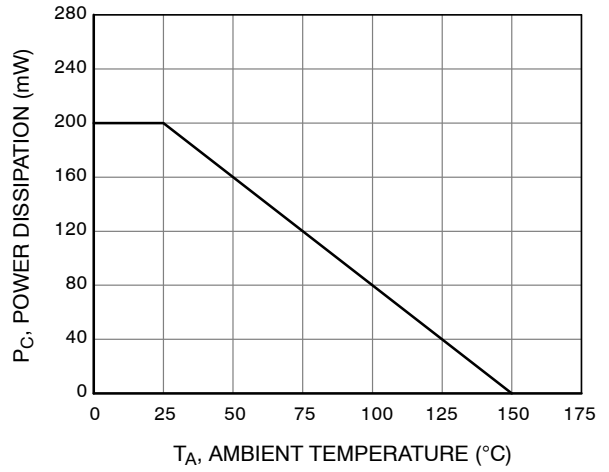
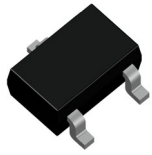

Figure 8. Power Derating

**MECHANICAL CASE OUTLINE**  
**PACKAGE DIMENSIONS**



**SC-70, 3 Lead, 1.25x2**  
**CASE 419AB**  
**ISSUE A**

DATE 13 FEB 2023

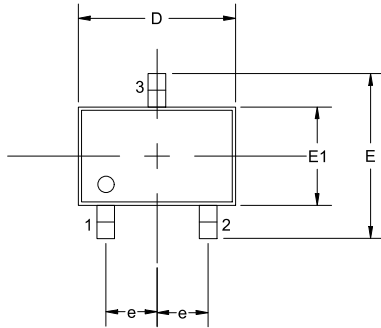

TOP VIEW

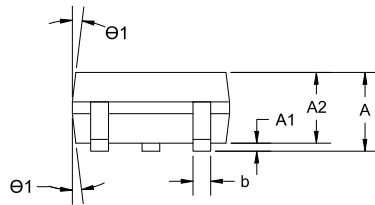

SIDE VIEW

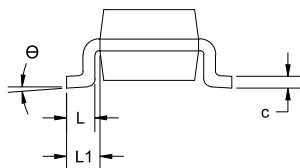

END VIEW

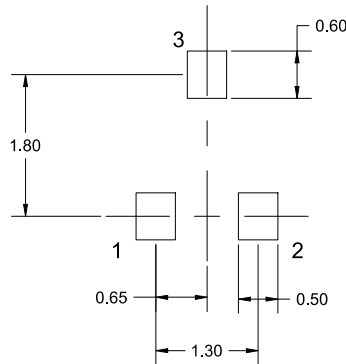

SOLDERING FOOTPRINT

NOTES:

1. ALL DIMENSIONS ARE IN MILLIMETERS. ANGLES IN DEGREES.
2. COMPLIES WITH JEDEC MO-203

| DIM | MILLIMETERS |      |      |
|-----|-------------|------|------|
|     | MIN.        | NOM. | MAX. |
| A   | 0.80        |      | 1.10 |
| A1  | 0.00        |      | 0.10 |
| A2  | 0.80        | 0.90 | 1.00 |
| b   | 0.15        |      | 0.30 |
| c   | 0.08        |      | 0.22 |
| D   | 1.80        | 2.00 | 2.20 |
| E   | 1.80        | 2.10 | 2.40 |
| E1  | 1.15        | 1.25 | 1.35 |
| e   | 0.65 BSC    |      |      |
| L   | 0.26        | 0.36 | 0.46 |
| L1  | 0.42 REF    |      |      |
| θ   | 0°          |      | 8°   |
| θ1  | 4°          |      | 10°  |

\* For additional information on our Pb-Free strategy and soldering details, please download the ON Semiconductor Soldering and Mounting Techniques Reference Manual, SOLDERRM/D.

|                         |                              |  |
|-------------------------|------------------------------|--|
| <b>DOCUMENT NUMBER:</b> | <b>98AON34256E</b>           | Electronic versions are uncontrolled except when accessed directly from the Document Repository. Printed versions are uncontrolled except when stamped "CONTROLLED COPY" in red. |
| <b>DESCRIPTION:</b>     | <b>SC-70, 3 LEAD, 1.25X2</b> | <b>PAGE 1 OF 1</b>   |

onsemi and ONSEMI are trademarks of Semiconductor Components Industries, LLC dba onsemi or its subsidiaries in the United States and/or other countries. onsemi reserves the right to make changes without further notice to any products herein. onsemi makes no warranty, representation or guarantee regarding the suitability of its products for any particular purpose, nor does onsemi assume any liability arising out of the application or use of any product or circuit, and specifically disclaims any and all liability, including without limitation special, consequential or incidental damages. onsemi does not convey any license under its patent rights nor the rights of others.

**onsemi**, **Onsemi**, and other names, marks, and brands are registered and/or common law trademarks of Semiconductor Components Industries, LLC dba "**onsemi**" or its affiliates and/or subsidiaries in the United States and/or other countries. **onsemi** owns the rights to a number of patents, trademarks, copyrights, trade secrets, and other intellectual property. A listing of **onsemi**'s product/patent coverage may be accessed at [www.onsemi.com/site/pdf/Patent-Marking.pdf](http://www.onsemi.com/site/pdf/Patent-Marking.pdf). **onsemi** reserves the right to make changes at any time to any products or information herein, without notice. The information herein is provided "as-is" and **onsemi** makes no warranty, representation or guarantee regarding the accuracy of the information, product features, availability, functionality, or suitability of its products for any particular purpose, nor does **onsemi** assume any liability arising out of the application or use of any product or circuit, and specifically disclaims any and all liability, including without limitation special, consequential or incidental damages. Buyer is responsible for its products and applications using **onsemi** products, including compliance with all laws, regulations and safety requirements or standards, regardless of any support or applications information provided by **onsemi**. "Typical" parameters which may be provided in **onsemi** data sheets and/or specifications can and do vary in different applications and actual performance may vary over time. All operating parameters, including "Typicals" must be validated for each customer application by customer's technical experts. **onsemi** does not convey any license under any of its intellectual property rights nor the rights of others. **onsemi** products are not designed, intended, or authorized for use as a critical component in life support systems or any FDA Class 3 medical devices or medical devices with a same or similar classification in a foreign jurisdiction or any devices intended for implantation in the human body. Should Buyer purchase or use **onsemi** products for any such unintended or unauthorized application, Buyer shall indemnify and hold **onsemi** and its officers, employees, subsidiaries, affiliates, and distributors harmless against all claims, costs, damages, and expenses, and reasonable attorney fees arising out of, directly or indirectly, any claim of personal injury or death associated with such unintended or unauthorized use, even if such claim alleges that **onsemi** was negligent regarding the design or manufacture of the part. **onsemi** is an Equal Opportunity/Affirmative Action Employer. This literature is subject to all applicable copyright laws and is not for resale in any manner.

---

## ADDITIONAL INFORMATION

### TECHNICAL PUBLICATIONS:

Technical Library: [www.onsemi.com/design/resources/technical-documentation](http://www.onsemi.com/design/resources/technical-documentation)  
onsemi Website: [www.onsemi.com](http://www.onsemi.com)

### ONLINE SUPPORT: [www.onsemi.com/support](http://www.onsemi.com/support)

For additional information, please contact your local Sales Representative at [www.onsemi.com/support/sales](http://www.onsemi.com/support/sales)

